

T 2 S, R 13 E, MICHIGAN MERIDIAN
CITY OF DETROIT, WAYNE CO.,
MICHIGAN

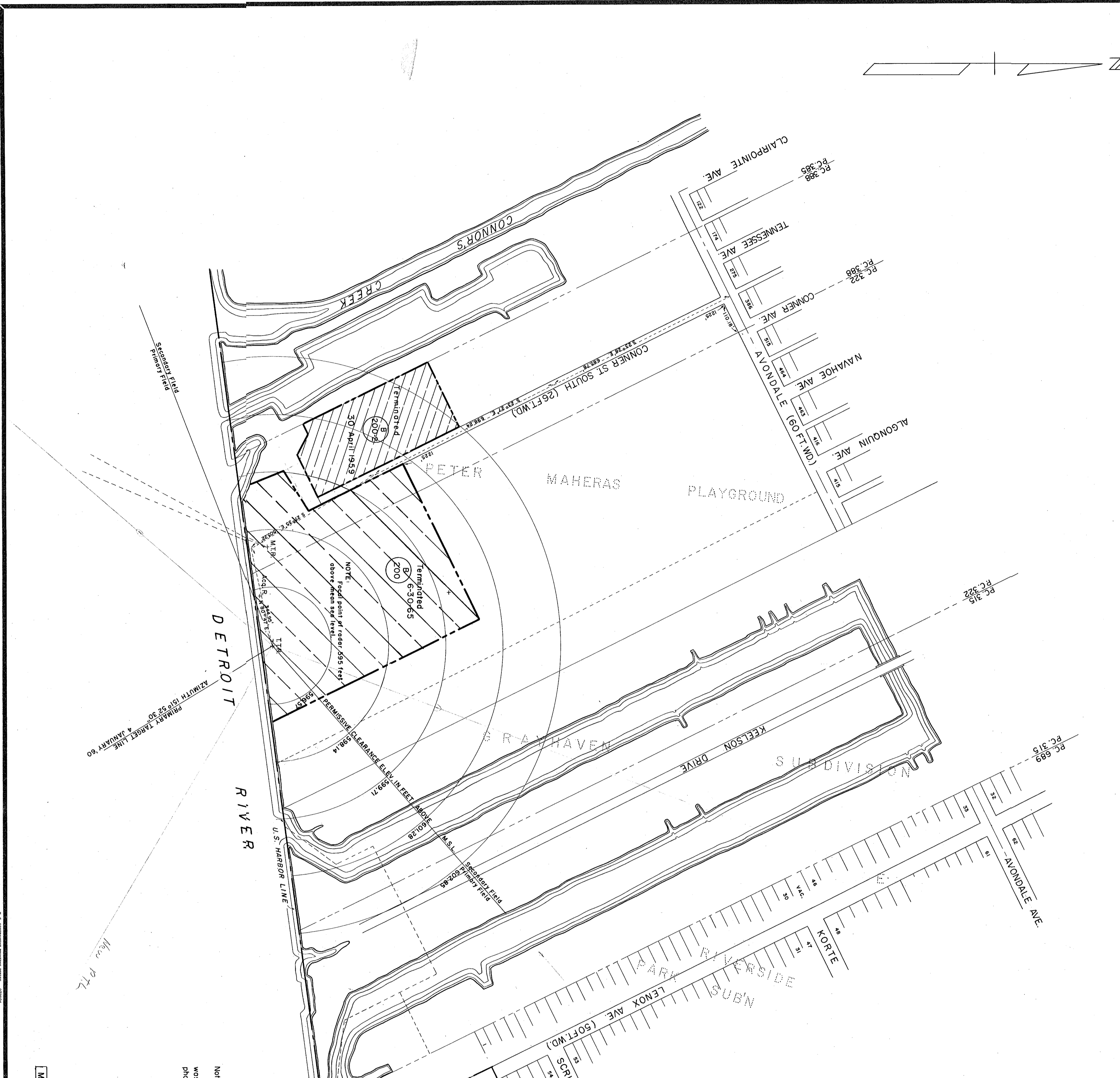

TRACT REGISTER OF ACQUISITION AFTER 1 JUL. 1940 (MILITARY)

TRACT NO.	LAND OWNER	ACREAGE	REMARKS
B-200	City of Detroit	10.30	
B-200-2	"	3.13	Lease No. DA-20-054-ENG-1078 441 Line 15.33 for control site from 20 April 1939, 1956 for Family Housing Site

PROJECT MAP
FINAL

AGENCY: DEPT. OF THE ARMY
STATE: MICHIGAN
COUNTY: WAYNE
DIVISION: NORTH CENTRAL
PROJECT AREA: DETROIT
ARMY AREA: 5TH
*TO LOUISVILLE DIST. 31 MAR-82

LOCATION OF PROJECT
CITY OF DETROIT
MILES OF

TRANSPORTATION FACILITIES
RAILROADS: DETROIT TERMINAL
STATE ROADS: M-102, M-29
FEDERAL ROADS: US-25
AIR LINES:

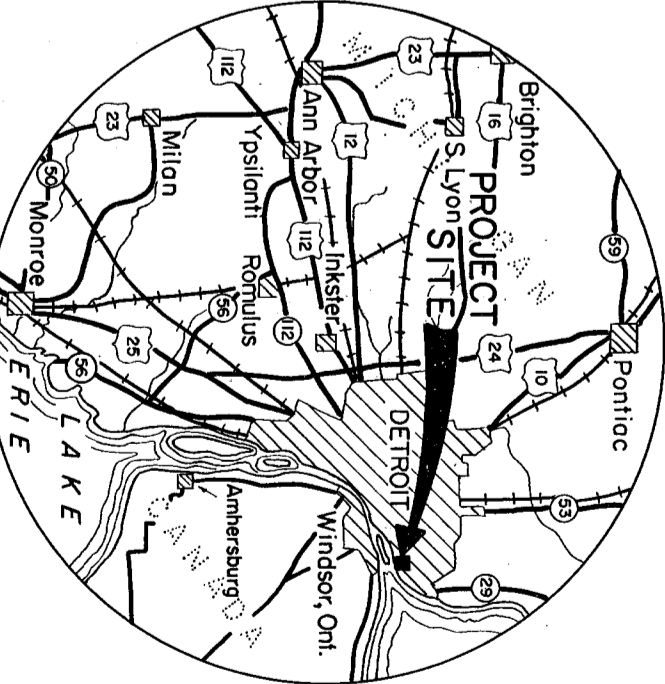
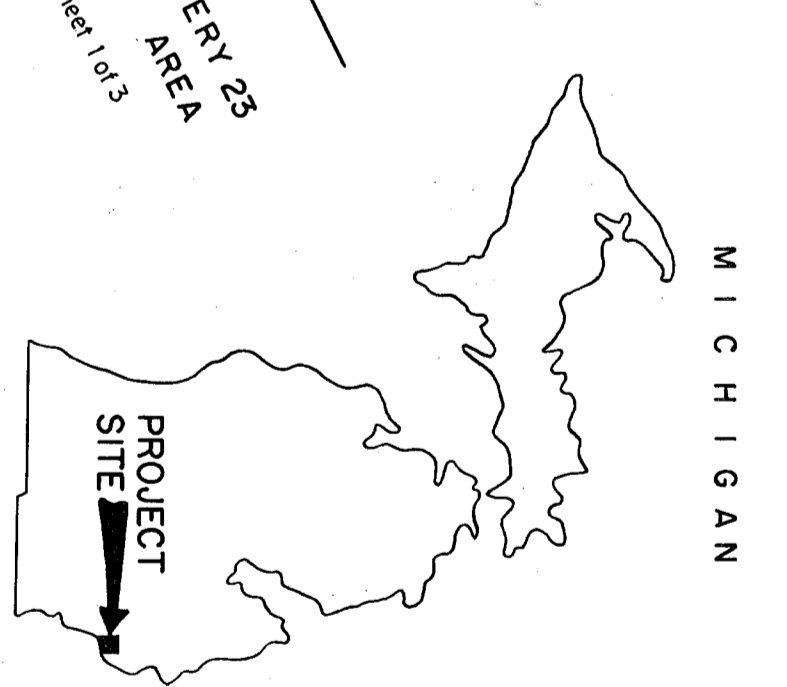
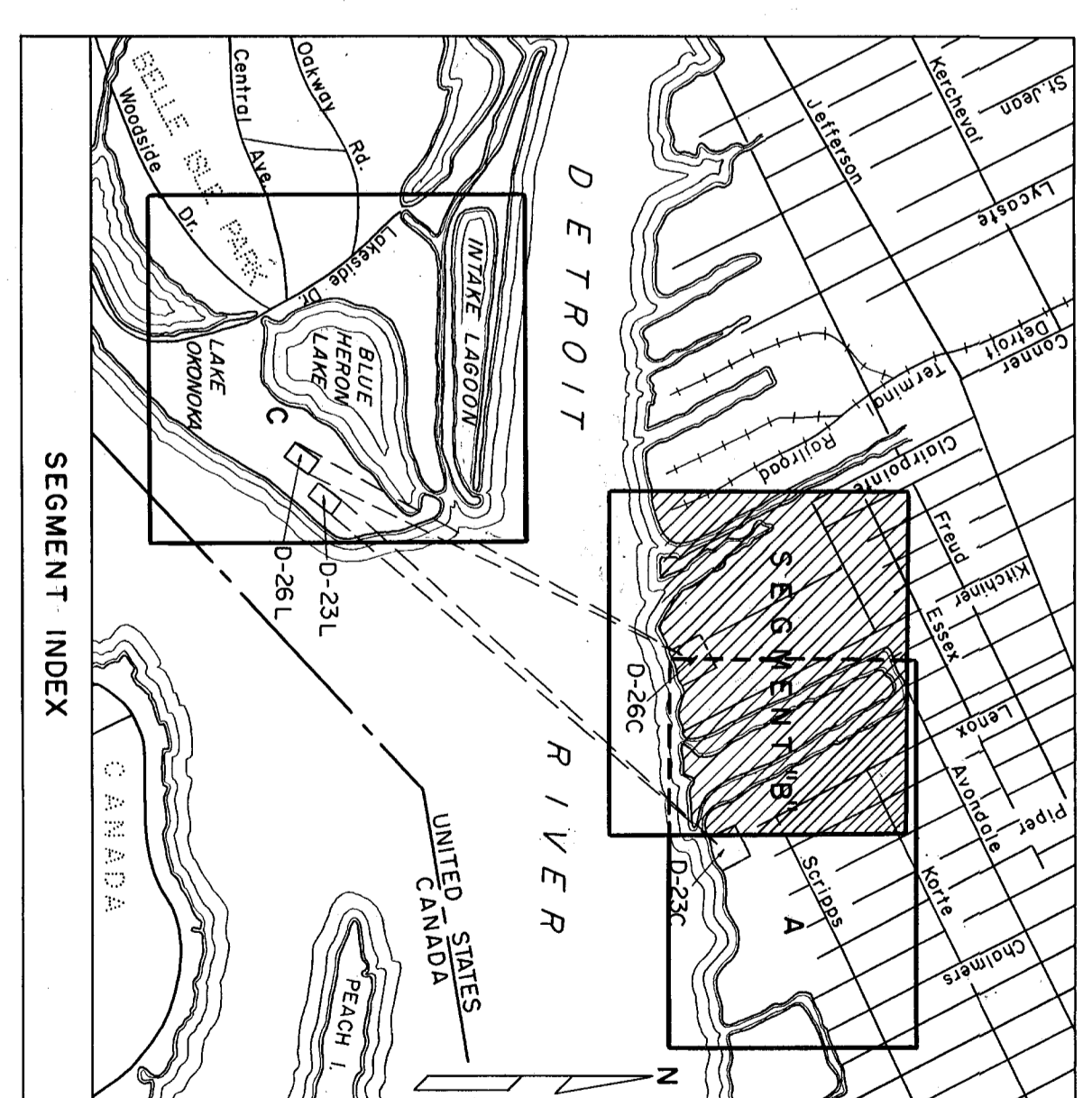

ACQUISITION AUTHORIZATION
REQ. 5876 dated 16 Feb. 1954
RE-D 5876B " 15 Feb. 1956

SEGMENT "B"
DEPARTMENT OF THE ARMY
OFFICE OF THE DISTRICT ENGINEER
NORTH CENTRAL DIVISION

REAL ESTATE
DETROIT DEFENSE AREA
NIKE BATTERIES 23-26
(D-26 CONTROL AREA)
MILITARY RESERVATION

DATE: 6 AUG. 1955

OFFICE CHIEF OF ENGINEERS WASHINGTON 25, D. C.
REAL ESTATE OFFICER
AUDITED

SCALE: 1" = 200' (Horizontal)
1" = 100' (Vertical)

DATE: 6 AUG. 1955

Note: The boundary of this installation was compiled from City plat maps, aerial photographs and construction drawings.

NO.	DATE	REVISIONS
M-3-1-5-73	21 Sept 50	Revised Final Audit Due to Audit

CLOSED

(NA) D-10-MICH-M