

CUTTER HOUSING PARTS

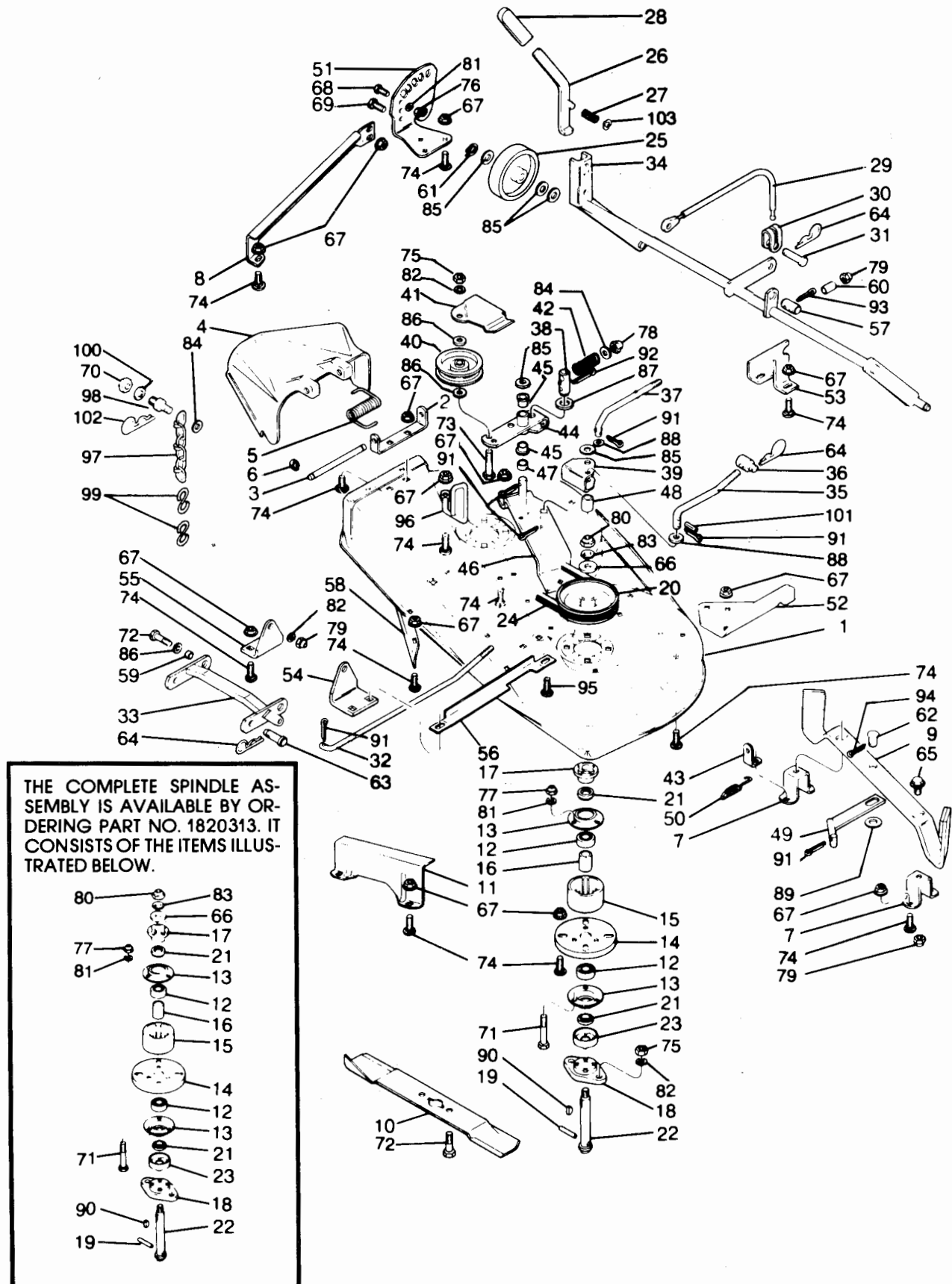

CUTTER HOUSING PARTS LIST

REF. NO.	PART NO.	DESCRIPTION	QTY.	REF. NO.	PART NO.	DESCRIPTION	QTY.
1	£ 1820185	Cutter Housing & Decal Assembly	1	54	1820240	Lift Bracket - L.H.	1
2	1820189	Chute Bracket	1	55	1820241	Lift Bracket - R.H.	1
3	1820188	Chute Shaft	1	56	1820242	Deck Brace	1
4	1820190	Chute Extension	1	57	1820243	Pivot Pin	1
5	1820191	Chute Spring	1	58	1820244	Baffle	1
6	1820922	"E"-Ring	2	59	1820246	Pivot Bushing	2
7	1820193	Support - Brake	2	60	1820010	Spacer	1
8	1820194	Deck Brace - R.H.	1	61	1820249	Retaining Ring	2
9	1820195	Brake Strap Assembly	1	62	1820250	Pin - Oval Head	1
10	1820196	Blade	2	63	1820251	Clevis Pin	2
11	£ 1820266	Belt Guard & Decal Assembly	1	64	1820252	Spring Clip	4
12	1820197	Bearing	4	65	1820142	Shoulder Bolt	2
13	1820198	Bearing Cup	4	66	1820255	Washer	2
14	1820199	Flange - Spindle	2	67	1820039	Washer Hd. Lock Nut 5/16-18	39
15	1820200	Housing	2	68	*	Cap Screw, Hex Hd. 1/4-20 x 5/8 Plated	1
16	1820201	Spacer	2	69	*	Cap Screw, Hex Hd. 5/16-18 x 3/4	2
17	1820202	Pulley Hub	2	70	*	Nut, Hex 3/8-16 Plated	1
18	1820203	Blade Adapter	2	71	*	Cap Screw, Hex Hd. 1/4-28 x 2-1/2 Plated & Heat Treated	6
19	1820204	Pin	2	72	*	Cap Screw, Hex Hd. 3/8-16 x 1-1/8 Plated & Heat Treated	6
20	1820205	Pulley Assembly	2	73	*	Cap Screw, Hex Hd. 3/8-16 x 2" Plated	1
21	1820206	Spacer - Offset	4	74	*	Bolt, Carriage 5/16-18 x 3/4 Plated	36
22	1820207	Shaft Assembly	2	75	*	Nut, Hex 3/8-16	5
23	1820208	Shield - Spindle	2	76	*	Nut, Hex 1/4 Plated	1
24	1820209	V-Belt	1	77	*	Nut, Hex Cone Lock 1/4-28 Plated	6
25	1820210	Wheel - Mower	2	78	*	Nut, Hex Cone Lock 5/16-18 Plated	1
26	1820211	Handle Assembly - Height Adjustment	1	79	*	Nut, Hex Cone Lock 3/8-16 Plated	5
27	1820212	Spring	1	80	*	Nut, Hex Cone Lock 7/16-14 Plated	2
28	1820923	Grip	1	81	*	Washer, Spring Lock 1/4 Plated	7
29	1820214	Lift Cable	1	82	*	Washer, Spring Lock 3/8	7
30	1820215	Lift Clevis	1	83	*	Washer, Spring Lock 7/16 Plated	2
31	1820216	Clevis Pin	1	84	*	Washer, Flat 5/16 Plated	2
32	1820217	Rod - Adjustment	1	85	*	Washer, Flat SAE 1/2 Plated	8
33	1820218	Mower Hanger Assembly	1	86	*	Washer, Flat SAE 3/8	4
34	1820219	Wheel Support Assembly	1	87	*	Washer, Flat SAE 5/8	1
35	1820220	Rod - Engagement	1	88	*	Washer, Flat SAE 5/16	2
36	1820221	Trunnion	1	89	*	Washer, Flat SAE 7/16 Plated	1
37	1820222	Rod - Clutch	1	90	*	Key, Woodruff 3/16 x 3/4	2
38	1820223	Pin - Clutch	1	91	*	Pin, Cotter 1/8 x 3/4 Plated	6
39	1820224	Arm - Over Center	1	92	*	Pin, Cotter 1/8 x 1" Plated	1
40	1820225	Idler Pulley - 4"	1	93	*	Pin, Cotter 3/16 x 1" Plated	1
41	1820226	Retainer - Belt	1	94	*	Pin, Cotter 3/32 x 3/4 Plated	1
42	1820137	Spring	1	95	1820253	Wafer Head Bolt	1
43	1820228	Spring Tab	1	96	1820264	Belt Guide - R.H. Spindle	1
44	1820229	Clutch Arm Assembly W/Bushings	1	97	1820245	Lift Chain	1
45	1820230	Bushing	2	98	1820247	Lift Pin	1
46	1820924	Pivot Assembly	1	99	1820248	"S" Hook	2
47	1820232	Spacer - Idler Arm	1	100	*	Washer, Spring Lock 3/8 Plated	1
48	1820233	Spacer - Over Center	1	101	*	Pin, Roll 1/8 x 3/4 Plated	1
49	1820234	Brake Link Assembly	1	102	1820270	Spring Clip	1
50	1820051	Brake Spring	1	103	1745949	Wave Washer	1
51	£ 1820236	Quadrant & Decal Assembly	1				
52	1820238	Axle Pivot - L.H.	1				
53	1820239	Brace - Axle	1				

* Common hardware. May be purchased locally.

£ All assemblies that list decals have only operational, instructional and safety decals. Other kinds of decals must be ordered separately.