

MODEL 51048SR
48 INCH MOWER ATTACHMENT

S/N 0100101-0199999

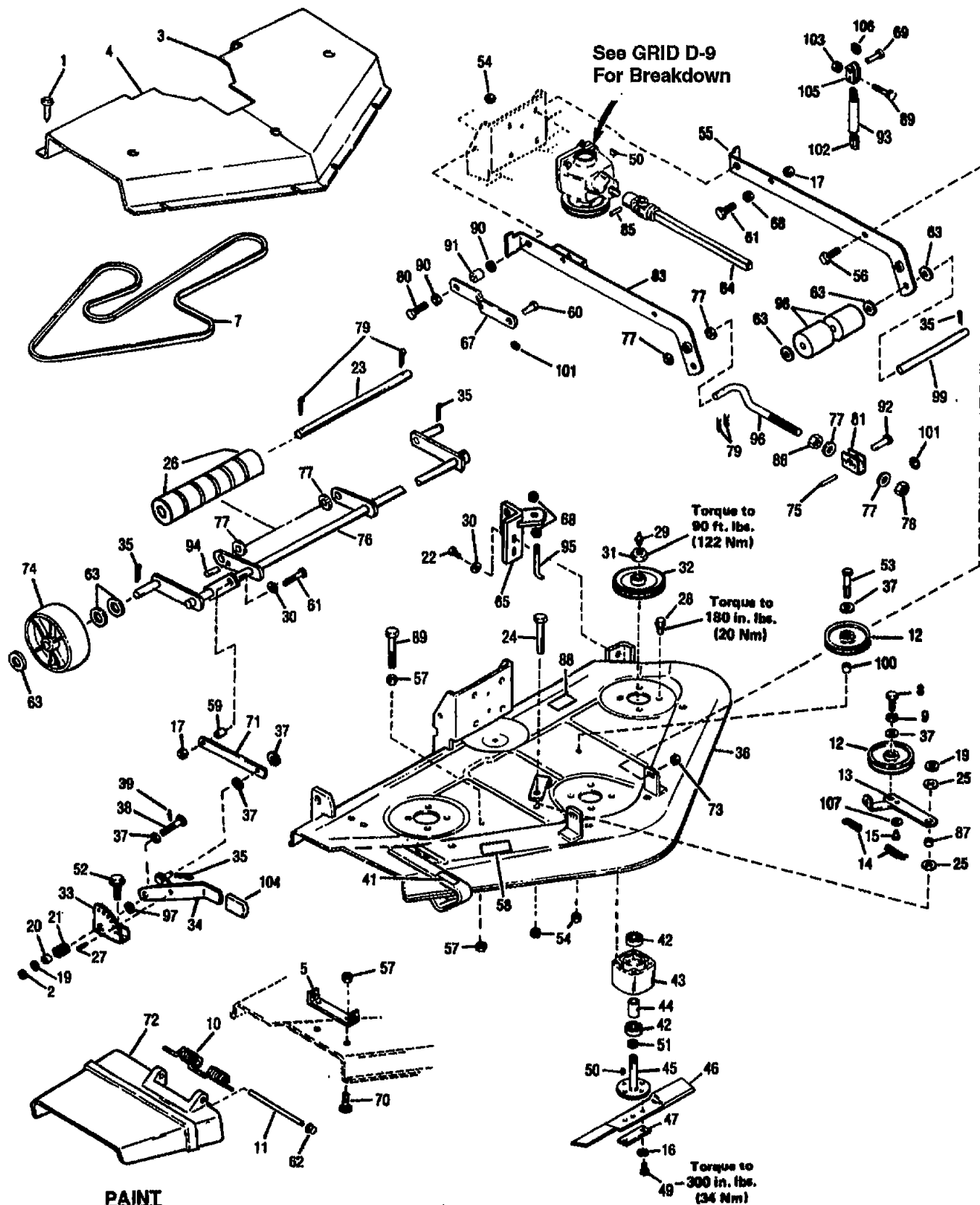

D-7

**MODEL 51048SR
48 INCH MOWER ATTACHMENT**

S/N 0100101-0199999

REF. NO.	PART NO.	DESCRIPTION	QTY. REQ.	REF. NO.	PART NO.	DESCRIPTION	QTY. REQ.
1	1185750	Self Driving Screw, 10-24 x 5/8	8	54	1734514	Lock Nut, 1/2-13	4
2 •	1185496	Lock Nut, 1/2-13	1	55	1751721GAR	Support Assembly, L.H.	1
3	1742483GAR	Belt Cover, L.H.	1	56 •	1186347	Flange Screw, 3/8-16 x 1 ...	2
4	1742482GAR	Belt Cover, R.H.	1	57	1732499	Top Locknut, 5/16-18	12
5	1728005GAR	Hinge Bracket	1	58	1750713	Caution Decal	1
6				59	1738160	Spacer	1
7	1750842	V-Belt (118.6)	1	60	1752309	Clevis Pin	2
8 •	1100015	Screw, Hex 1/2-20 x 1-1/4 ..	1	61 •	1100047	Capscrew, 3/8-16 x 1-1/2 ...	3
9 •	1100245	Lockwasher, 1/2	1	62	1724791	Push Nut	2
10	1756596	Spring	1	63 •	1107386	Flat Washer, 5/8	13
11	1756760	Rod	1	65	1748097GAR	Shaft Support Assembly ...	1
12	1752354	Idler Pulley	2	66 •	1107382	Flat Washer, 5/16	4
13	1724923GAR	Idler Arm	1	67	1746169GAR	Drag Link	2
14	1724822	Extension Spring	1	68 •	1185506	Jam Nut, 3/8-16	4
15	1724924	Wear Button	1	69	1708126	Clevis Pin	2
16 •	1100243	Lockwasher, 3/8	6	70	1736098	Carriage Bolt, 5/16-18 x 5/8 .	2
17	1733398	Lock Nut, 3/8-16	3	71	1755887GAR	Link, Connecting	1
19 •	1107385	Flat Washer, 1/2	2	72	1755750	Discharge Chute	1
20	1715387	Spacer	1	73 •	1186393	Flange Nut, 3/8-16	2
21	1716583	Spring	1	74	1740589	Gage Wheel	2
22 •	1100046	Hex Screw, 3/8-16 x 1	2	75	1185597	Roll Pin	4
23	1738111	Axle Roller	1	76	1748077GAR	Pivot Shaft Assembly	1
24 •	1100064	Capscrew, 1/2-13 x 1-1/2 ...	1	77	1185830	Flat Washer	15
25	1724929	Thrust Washer	2	78	1110113	Hex Nut, 3/4-10	2
26	1754611	Roller (2" Long)	6	79 •	1100351	Cotter Pin, 1/8 x 1-1/4	6
27	1733103	Drive Pin, 5/16-18 x 3/4	1	80 •	1100065	Hex Screw, 1/2-13 x 1-3/4 ...	2
28	1724491	Flange Screw, 5/16-18 x 3/4 .	12	81	1746171GAR	Hitch Bracket	2
29	1185976	Grease Fitting	3	83	1751722GAR	Support Assembly, R.H.	1
30 •	1107383	Flat Washer, 3/8	3	84	1755803	Drive Assembly	1
31 •	1185093	Locknut, 3/4-16	3	85	1185376	Roll Pin, 3/16 x 1-1/2	1
32	1752307	Blade Sheave	3	86	1186236	Hex Nut, 3/4-10	2
33	1755876GAR	Quadrant	1	87	1728030	Sleeve Bearing	1
34	1755886GAR	Handle Assembly	1	88	1757419	Belt Drive Decal	1
35 •	1100350	Cotter Pin, 1/8 x 1	4	89 •	1100808	Hex Screw, 5/16-18 x 1-1/4 ..	3
36	1757517	Mower Base w/Decals (Incl. No. 41, 58 & 88)	1	90 •	1100257	Flat Washer, 1/2	4
37 •	1890234	Flat Washer, 1/2	5	91	1746172	Spacer	2
38	1755872	Special Screw	1	92	1752308	Clevis Pin	2
39	1185256	Roll Pin, 3/16 x 7/8	1	93	1755800	Sleeve	2
41	1744491	Decal, Cutting Line	1	94	1177625	Drive Pin, 1/8 x 3/4	1
42	1185828	Ball Bearing	6	95	1742328	Hook	2
43	1724029	Spindle Housing	3	96	1746170GAR	Hitch Link	2
44	1746889	Spacer	3	97	1724927	Spacer	1
45	1742606	Shaft Assembly	3	98	1751704	Roller	2
46	1738571	Blade	3	99	1751705	Roller Shaft	1
47	1724051	Plate	3	100	1730681	Spacer	1
49 •	1100009	Capscrew, 3/8-24 x 1	6	101	1751909	Wire Spring Pin	4
50	1104436	Woodruff Key, 3/16 x 3/4 ...	4	102	1752129	Chain	2
51	1740827	Flat Washer, Special	3	103 •	1110107	Lock Nut, 5/16-18	2
52	1186329	Flange Screw, 5/16-18 x 3/4 .	1	104	1753978	Grip	1
53 •	1100067	Hex Screw, 1/2-13 x 2	1	105	1753009	Clevis Pin	2
				106	1751908	Wire Circle Ring	2
				107 •	1103959	Flat Washer	1

• Common Hardware — Purchase Locally (Grade 5 where applicable)

MODEL 51048SR
48 INCH MOWER ATTACHMENT

S/N 0100101-0199999

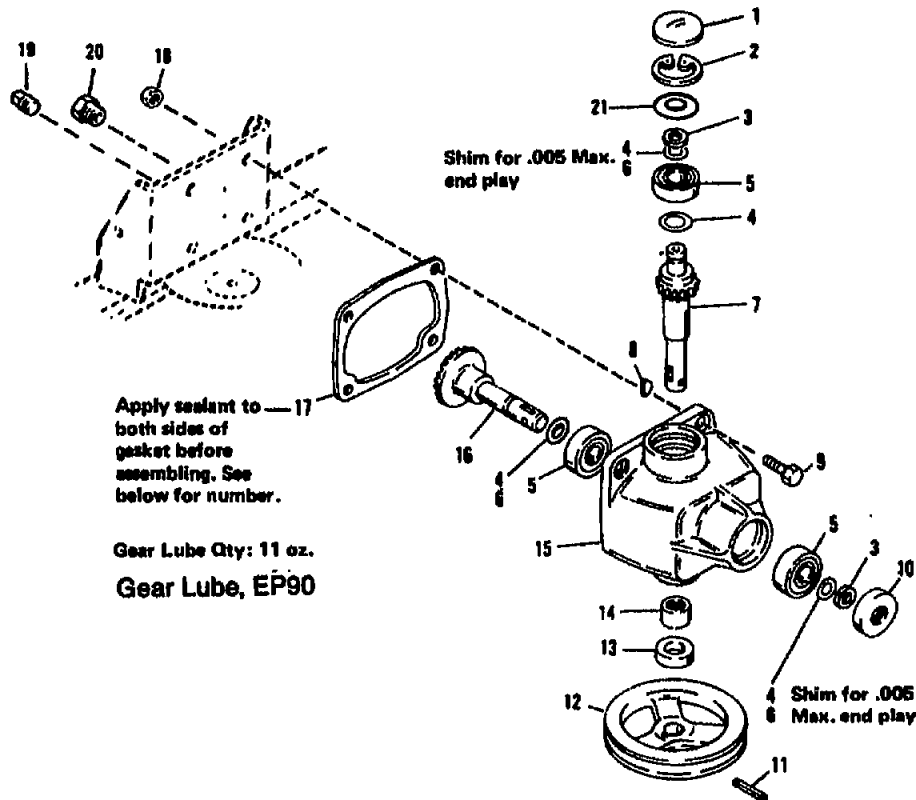

REF. NO.	PART NO.	DESCRIPTION	QTY. REQ.	REF. NO.	PART NO.	DESCRIPTION	QTY. REQ.
1	1711380	Expansion Plug	1	12	1744919	Drive Sheave	1
2	1118730	Retaining Ring	1	13	1185296	Oil Seal	1
3	1185649	Retaining Ring	2	14	1185280	Needle Bearing	1
4	1728832	Shim Washer .005	AR	15	1723754 010	Gear Case	1
5	1724813	Ball Bearing	3	16	1724906	Bevel Gear, 26T	1
6	1728833	Shim .010	AR	17	1745476	Gear Case Gasket	1
7	1724905	Output Shaft	1	18	1732499	Top Lock Nut, 5/16-18	4
8	1104436	Woodruff Key, 3/16 x 3/4 ...	1	19	1105678	Square Plug, 3/8 NPT	1
9 •	1100808	Hex Hd. Capscrew, 5/16-18 x 1-1/4	4	20	1721442	Pressure Relief Valve	1
10	1723758	Oil Seal	1	21	1718781	Shim .005	AR
11	1737419	Drive Pin, 1/4 x 1-1/2	1	NI		Gear Lube, EP90	
				NI	1730118	Sealant 3 oz.	

• Common Hardware — Purchase Locally (Grade 5 where applicable)