

SUBURBAN TRACTOR

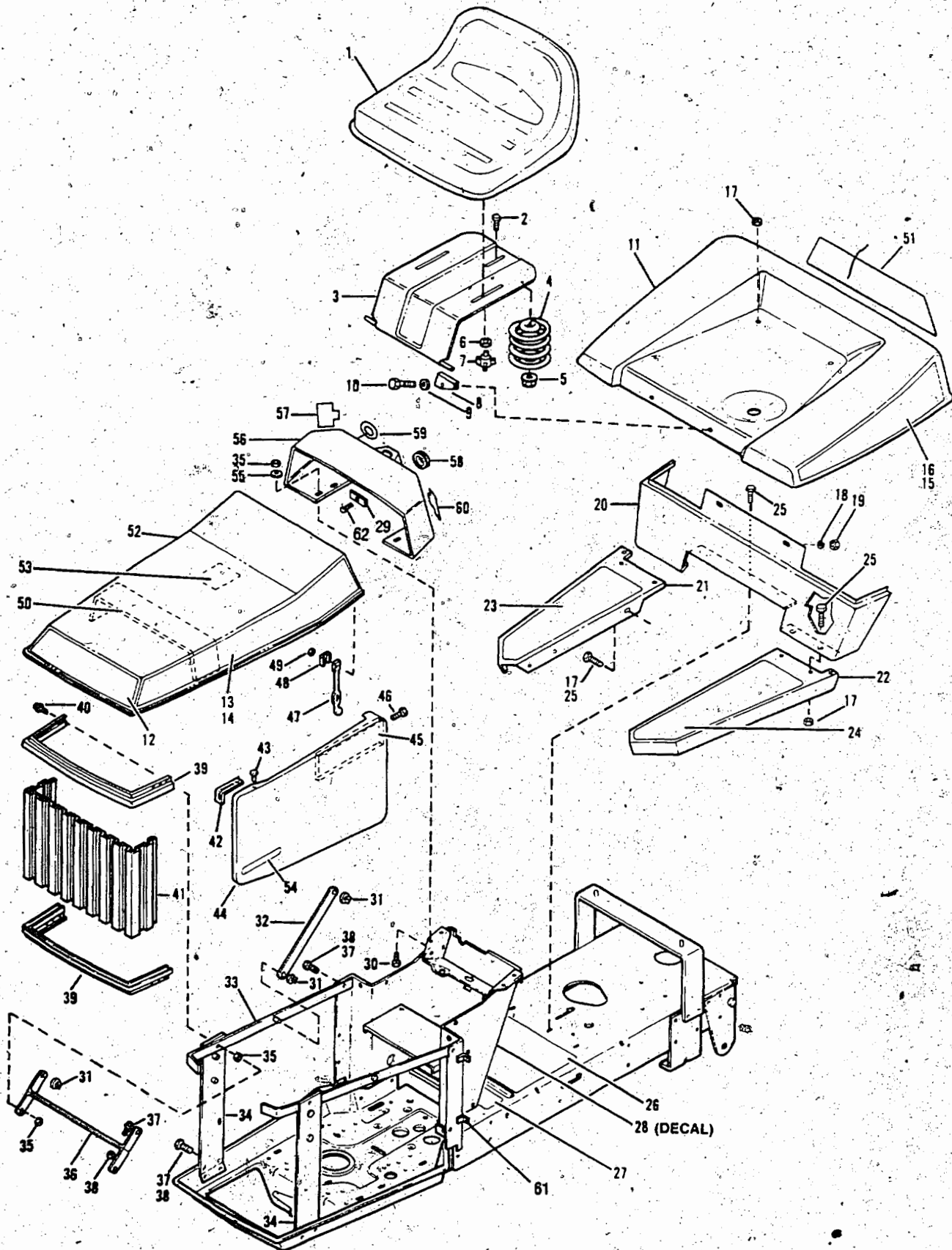

BODY WORK AND TRIM ASSEMBLY

MODELS 3012H AND 3016H

| REF. NO. | PART NO. | DESCRIPTION | NO. REQ'D | REF. NO. | PART NO. | DESCRIPTION | NO. REQ'D |
|----------|-----------|--|-----------|----------|-----------|--------------------------------------|-----------|
| 1 | 1747835 | Seat (3012H) | 1 | 33 | 1744062 | Hinge Strap Assembly | 2 |
| | 1747834 | Seat (3016H) | 1 | 34 | 1744027 | Grille Support Assembly (A) | 2 |
| 2 | • 1186130 | Rd. Hd. Sq. Neck Screw 3/8-16 x 10 1/4 | 1 | | 1752914 | Grille Support Assembly (B) | 2 |
| 3 | 1743434 | Seat Support Assembly | 1 | 35 | 1734398 | Lock Nut 1/4-20 | 8 |
| 4 | 1733960 | Compression Spring | 1 | 36 | 1742458 | Hinge Link | 2 |
| 5 | 1735125 | Nut & Washer Assembly | 1 | 37 | • 1186309 | Flange Lock Screw 1/4-20 x 5/8 | 12 |
| 6 | • 1107383 | Flat Washer 3/8 | 2 | 38 | • 1186389 | Flange Lock Nut 1/4-20 | 12 |
| 7 | 1734269 | Knob | 2 | 39 | 1742493 | Grille Cap | 2 |
| 8 | 1735265 | Pivot Block | 2 | 40 | • 1100069 | Hex Hd. Screw 1/4-20 x 1 | 2 |
| 9 | • 1100255 | Flat Washer 5/16 | 2 | 41 | 1742494 | Grille | 1 |
| 10 | • 1100799 | Hex Screw 5/16-18 x 1-1/2 | 2 | 42 | 1743566 | Side Cover Guide | 4 |
| 11 | 1742810 | Rear Fender | 1 | 43 | • 1186059 | Pop Rivet 1/8 x 1/4 | 8 |
| 12 | 1747663 | Hood Decal | 1 | 44 | 1743554 | L.H. Side Cover | 1 |
| 13 | 1747670 | Hood Decal R.H. | 1 | | 1743553 | R.H. Side Cover | 1 |
| 14 | 1747671 | Hood Decal L.H. | 1 | 45 | 1744065 | Sealing Block | 2 |
| 15 | 1750915 | Fender Decal R.H. (3012H) | 1 | 46 | • 1115815 | Phil. Hd. Machine Screw #10-24 x 5/8 | 4 |
| | 1747668 | Fender Decal R.H. (3016H) | 1 | 47 | 1727127 | Rubber Latch | 2 |
| 16 | 1750916 | L.H. Fender Decal (3012H) | 1 | 48 | 1727126 | Clip | 2 |
| | 1747669 | L.H. Fender Decal (3016H) | 1 | 49 | 1185985 | Keps Nut #10-24 | 2 |
| 17 | • 1186391 | Flange Nut 5/16-18 | 7 | 50 | 1744067 | Sealing Strip | 1 |
| 18 | • 1100242 | Lock Washer 5/16 | 2 | 51 | 1751874 | Fender Decal | 1 |
| 19 | • 1186230 | Hex Nut 5/16-18 | 2 | 52 | 1744051 | Hood Assembly | 1 |
| 20 | 1743987 | Running Board Support | 1 | 53 | 1744570 | Service Instrument Decal | 1 |
| 21 | 1747028 | R.H. Running Board (A) | 1 | 54 | 1747662 | Side Cover Decal | 2 |
| | 1751805 | R.H. Running Board (B) | 1 | 55 | • 1107381 | Flat Washer 1/4 | 4 |
| 22 | 1743988 | L.H. Running Board (A) | 1 | 56 | 1750686 | Instrument Panel | 1 |
| | 1751803 | L.H. Running Board (B) | 1 | 57 | 1750669 | Throttle Decal | 1 |
| 23 | 1742665 | R.H. Foot Pad | 1 | 58 | 1747144 | Cap (3012H) | 2 |
| 24 | 1742664 | L.H. Foot Pad | 1 | 59 | 1750779 | Decal, Ignition | 1 |
| 25 | • 1186330 | FL. Lock Screw 5/16-18 x 7/8 | 9 | 60 | 1750671 | Choke Decal | 1 |
| 26 | 1742666 | Center Foot Pad | 1 | 61 | 1742934 | Angle Speed Nut | 4 |
| 27 | 1750325 | Instruction Decal | 1 | 62 | 1750767 | Lense | 1 |
| 28 | 1750938 | Operating Instrument Decal | 1 | 63 | 1186020 | Thd Cut Screw 6-32 x 3/8 | 1 |
| 29 | 1751089 | Retainer | 1 | | | | |
| 30 | • 1111599 | Hex Hd. Screw 1/4-20 x 5/8 | 4 | | | | |
| 31 | 1747836 | Retaining Ring | 6 | | | | |
| 32 | 1742459 | Hinge Link | 2 | | | | |

• Common Hardware - Purchase Locally

(A) 3012 S/N 0100101 - 0199999

3016 S/N 0300101 - 0399999

(B) 3012 S/N 0200101 - 0299999

3016 S/N 0400101 - 0499999

SUBURBAN TRACTOR

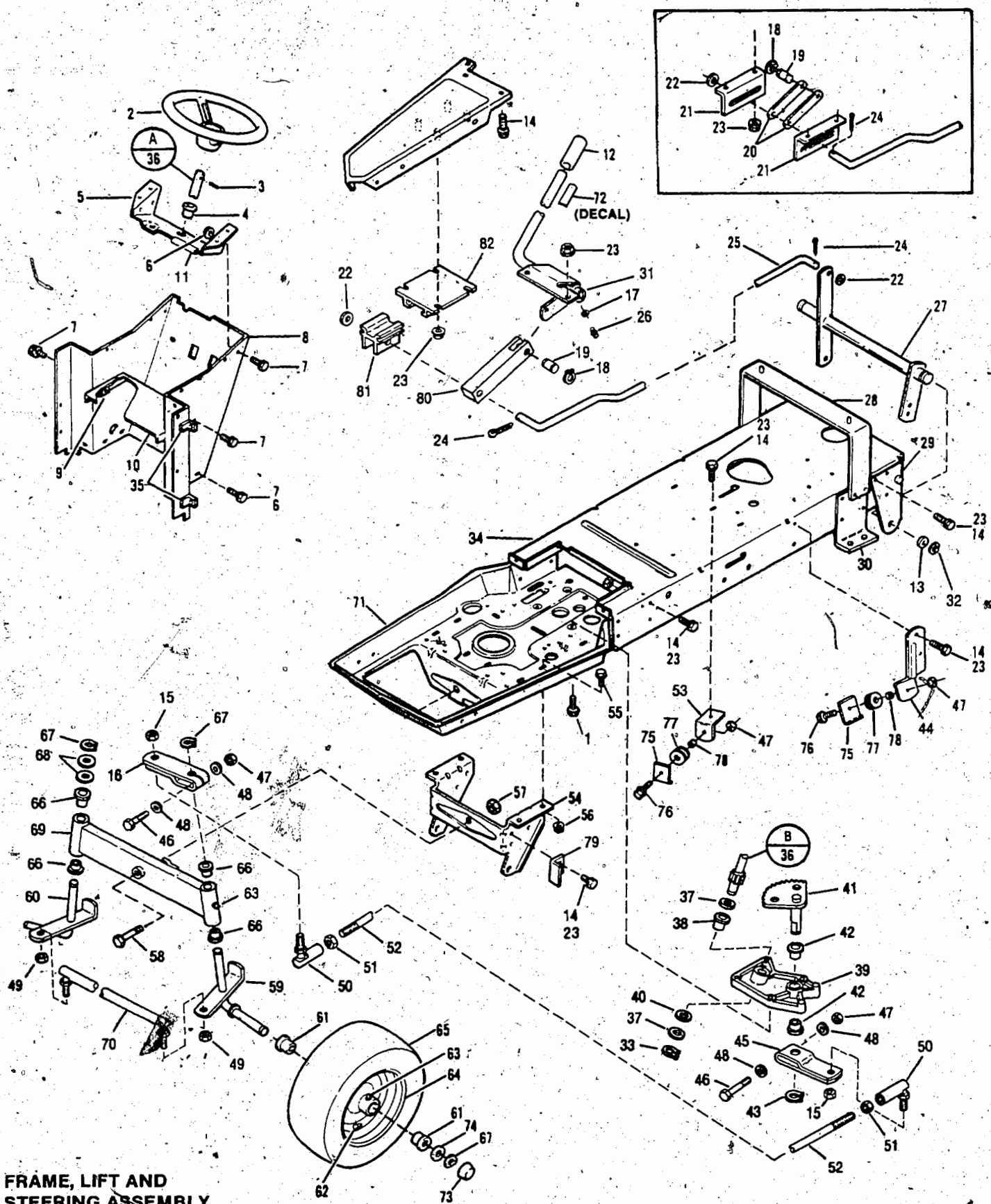

MODELS 3012H AND 3016H

| REF. NO. | PART NO. | DESCRIPTION | NO. REQ'D |
|----------|-----------|---------------------------------|-----------|
| 1 | 1724491 | Thd Screw 5/16-18 x 3/4 | 4 |
| 2 | 1747804 | Steering Wheel (3016H) | 1 |
| | 1727284 | Steering Wheel (3012H) | 1 |
| 3 | • 1185279 | Roll Pin 1/4 x 2-1/4 | 1 |
| 4 | 1185632 | Flange Bearing | 1 |
| 5 | 1743546 | Steering Shaft Support (A) | 1 |
| | 1752363 | Steering Shaft Support (B) | 1 |
| 6 | • 1186389 | Flange Nut 1/4-20 | 13 |
| 7 | • 1186309 | Flange Screw 1/4-20 x 5/8 | 17 |
| 8 | 1750117 | Instr. Panel Support (A) | 1 |
| | 1752880 | Instr. Panel Support (B) | 1 |
| 9 | 1185456 | U Type Speed Nut 1/4-20 | 4 |
| 10 | 1742172 | Battery Support | 1 |
| 11 | 1744580 | Seal Strip | 1 |
| 12 | 1736931 | Handle Grip | 1 |
| 13 | 1185830 | Flat Washer | 4 |
| 14 | • 1186330 | Flange Lock Screw 5/16-18 x 7/8 | 38 |
| 15 | 1750957 | Lock Jam Nut 1/2-20 | 2 |
| 16 | 1750495 | Steering Arm | 1 |
| 17 | 1805368 | Washer | 1 |
| 18 | 1185427 | Retaining Ring | 2 |
| 19 | 1747189 | Pin | 1 |
| 20 | 1747030 | Lift Link (A) | 2 |
| 21 | 1745635 | Bracket (A) | 2 |
| 22 | • 1107385 | Flat Washer 1/2 | 2 |
| 23 | • 1186391 | Flange Lock Nut 5/16-18 | 42 |
| 24 | • 1100350 | Cotter Pin 1/8 x 1 | 2 |
| 25 | 1745643 | Lift Rod (A) | 1 |
| | 1751070 | Lift Rod (B) | 1 |
| 26 | 1185803 | Grease Fitting | 1 |
| 27 | 1749997 | Lift Shaft Assembly (A) | 1 |
| | 1752414 | Lift Shaft Assembly (B) | 1 |
| 28 | 1743430 | Fender Support Assembly | 1 |
| 29 | 1749801 | Rear Panel Assembly | 1 |
| 30 | 1740984 | Axle Support | 2 |
| 31 | 1749028 | Lift Lever Assembly | 1 |
| 32 | 1185388 | Retaining Ring | 2 |
| 33 | 1177567 | Retaining Ring | 1 |
| 34 | 1750127 | Rear Frame | 1 |
| 35 | 1742934 | Angle Bracket Speed Nut | 4 |
| 36 | 1751284 | Steering Shaft | 1 |
| 37 | 1730375 | Shim Washer | 3 |
| 38 | 1747303 | Flange Bearing | 1 |
| 39 | 1750594 | Steering Support Assembly | 1 |
| 40 | 1715301 | Thrust Washer | 1 |

| REF. NO. | PART NO. | DESCRIPTION | NO. REQ'D |
|----------|-----------|-------------------------------|-----------|
| 41 | 1750501 | Sector Gear Assembly | 1 |
| 42 | 1185386 | Flange Bearing | 2 |
| 43 | 1113527 | Retaining Ring | 1 |
| 44 | 1747315 | Bracket | 1 |
| 45 | 1750581 | Spindle Arm Assembly | 1 |
| 46 | • 1100049 | Hex Head Screw 3/8-16 x 2-1/4 | 1 |
| 47 | • 1733398 | Hex Lock Nut 3/8-16 | 4 |
| 48 | • 1708755 | Flat Washer 3/8 | 4 |
| 49 | 1110150 | Lock Nut 3/8-24 | 4 |
| 50 | 1716180 | Ball Joint | 2 |
| 51 | 1186247 | Jam Hex Nut 1/2-20 | 2 |
| 52 | • 1750499 | Steering Rod | 1 |
| 53 | 1747316 | Bracket | 1 |
| 54 | 1750811 | Attachment Bracket | 1 |
| 55 | • 1186345 | Flange Hex Screw 3/8-16 x 3/4 | 4 |
| 56 | • 1186393 | Flange Hex Nut 3/8-16 | 4 |
| 57 | 1110112 | Lock Hex Nut 5/8-11 | 1 |
| 58 | 1744453 | Hex Hd. Screw 5/8-11 x 2-1/4 | 1 |
| 59 | 1750486 | L.H. Spindle Assembly | 1 |
| 60 | 1750490 | R.H. Spindle Assembly | 1 |
| 61 | 1720327 | Bushing | 4 |
| 62 | 1718086 | Valve Stem | 2 |
| 63 | 1185976 | Grease Fitting | 4 |
| 64 | 1750924 | Wheel | 2 |
| 65 | 1750354 | Tire 15 x 6.00-6 | 2 |
| 66 | 1742133 | Flange Bearing | 4 |
| 67 | 1185388 | Retaining Ring | 4 |
| 68 | 1701447 | Washer | A/R |
| 69 | 1750494 | Front Axle Assembly | 1 |
| 70 | 1750841 | Tire Rod | 1 |
| 71 | 1742343 | Front Frame | 1 |
| 72 | 1744013 | Lift Decal | 1 |
| 73 | 1744444 | Wheel Cap | 2 |
| 74 | 1185830 | Special Washer | A/R |
| 75 | 1747320 | Cable Guide | 2 |
| 76 | • 1100043 | Hex Screw 3/8-16 x 1-1/4 | 2 |
| 77 | 1862273 | Pulley | 2 |
| 78 | 1747322 | Spacer | 2 |
| 79 | 1751715 | Bracket | 2 |
| 80 | 1752412 | Push Link (B) | 1 |
| 81 | 1751067 | Sliding Guide (B) | 1 |
| 82 | 1751069 | Stationary Guide (B) | 1 |

• Common Hardware Purchase Locally (Grade 5 where applicable)

(A) 3012 S/N 0100101 - 0199999
 3016 S/N 0300101 - 0399999
 (B) 3012 S/N 0200101 - 0299999
 3016 S/N 0400101 - 0499999

MODELS 3012H AND 3016H

| REF. NO. | PART NO. | DESCRIPTION | NO. REQ'D |
|----------|----------|------------------------------------|-----------|
| 1 | 1744390 | Fuel Tank Pad | 1 |
| 2 | 1747733 | Fuel Tank Gauge | 1 |
| 3 | 1747537 | Fuel Tank (Incl. Ref. 2) | 1 |
| 4 | 1752795 | Fuel Line | 1 |
| 5 | 1750687 | Hose Clamp | 2 |
| 6 | 1751477 | Fuel Shut Off Valve | 1 |
| 7 | 1738433 | Bushing | 1 |
| 8 | 1736314 | Knob | 2 |
| 9 | 1743511 | Throttle Control | 1 |
| 10 | 1743512 | Choke Control (3016H) | 1 |
| 11 | 1115815 | Phil. Hd. Screw #10-24 x 5/8 | 8 |
| 12 | 1185985 | Keps Nut #10-24 | 4 |
| 13 | 1743907 | Heat Shield (A) | 1 |
| | 1752882 | Heat Shield (B) | 1 |
| 14 | 1727491 | Fuel Filter | 1 |
| 15 | 1744066 | Heat Shield | 1 |
| 16 | * | Engine, B & S 16 H.P. | |
| | | Model 402707 | 1 |
| | * | Engine, B & S 12 H.P. | |
| | | Model 404700 | 1 |
| 17 | 1186230 | Hex Nut 5/16-18 | 4 |
| 18 | 1100242 | Lock Washer 5/16 | 4 |
| 19 | 1732137 | Sealing Strip | 1 |

| REF. NO. | PART NO. | DESCRIPTION | NO. REQ'D |
|----------|----------|--|-----------|
| 20 | 1735531 | Wire Tie | 3 |
| 21 | 1747738 | J-Clip | 1 |
| 22 | 1745366 | Cable Hanger | 3 |
| 23 | 1743683 | Street Elbow, 45° | 1 |
| 24 | 1743685 | Pipe Nipple | 1 |
| 25 | 1743684 | Elbow, 90° | 1 |
| 26 | 1744455 | Special Washer | 1 |
| 27 | 1100244 | Lock Washer 7/16 | 1 |
| 28 | 1748383 | Heat Shield | 1 |
| 29 | 1744454 | Hex Screw 7/16-20 x 3 | 1 |
| 30 | 1185986 | Speed Nut #10-24 | 5 |
| 31 | 1186391 | Fl. Nut 5/16-18 | 2 |
| 32 | 1743984 | Clutch Stop (A) | 1 |
| 33 | 1100779 | Screw, Hex Hd. 5/16-18 x 1-3/4 (A) | 1 |
| | 1111606 | Screw, Hex Hd. 5/16-18 x 2 (B) | 1 |
| 34 | 1100799 | Hex Hd. Screw 5/16-18 x 1-1/2 | 3 |
| 35 | 1748146 | Sq. Key 1/4 x 2-1/2 | 1 |
| 36 | 1742535 | Sheave | 1 |
| 37 | 1742518 | Electric Clutch | 1 |
| 38 | 1752922 | Clutch Retainer (A) | 1 |
| 39 | 1100255 | Flat Washer 5/16 (B) | 1 |
| 40 | 1110645 | Lock Washer 5/16 (B) | 1 |

* Order Parts from your local Briggs & Stratton Engine Dealer
 • Common Hardware - Purchase Locally

(A) 3012 S/N 0100101 - 0199999
 3016 S/N 0300101 - 0399999
 (B) 3012 S/N 0200101 - 0299999
 3016 S/N 0400101 - 0499999

SUBURBAN TRACTOR

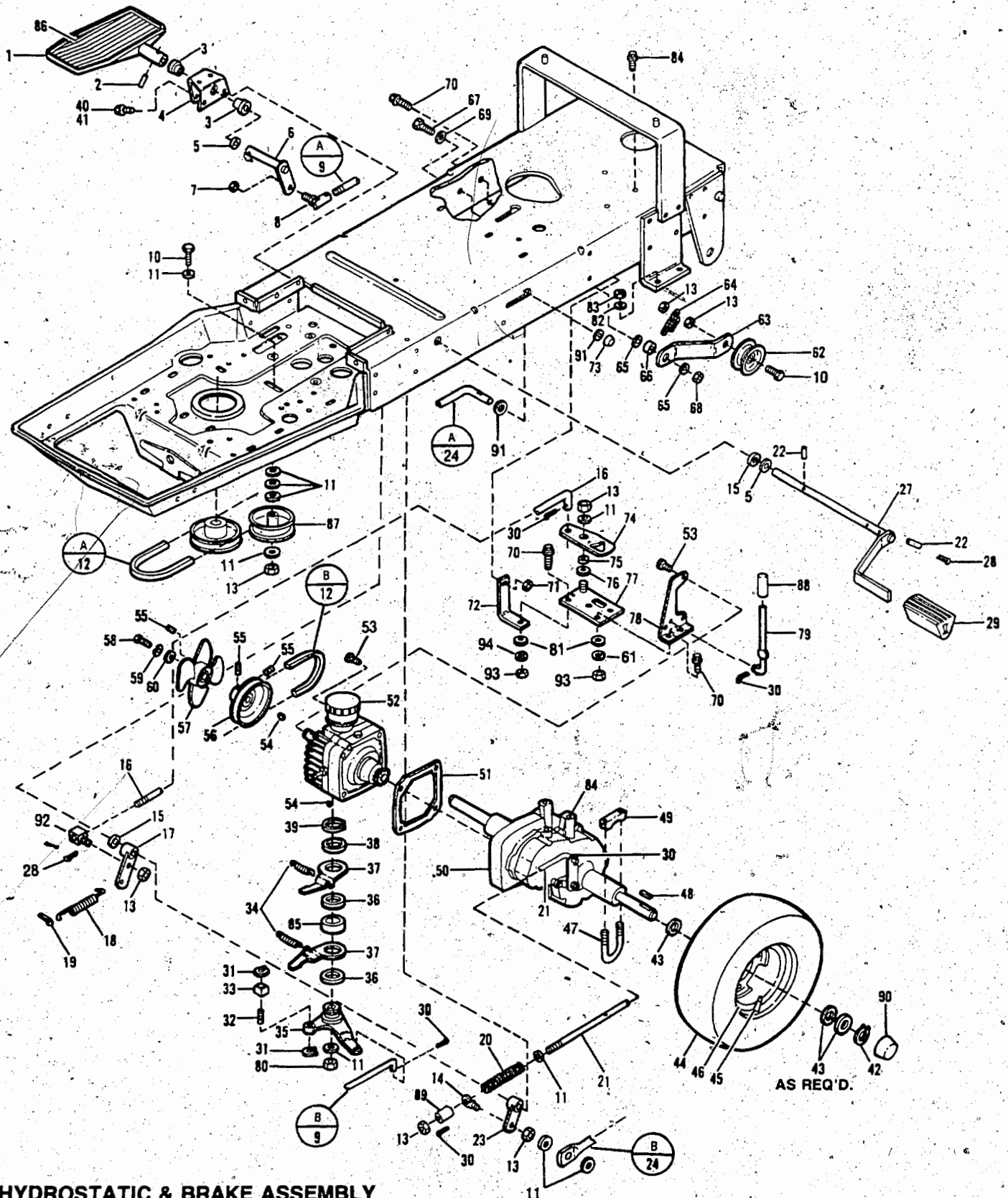

HYDROSTATIC & BRAKE ASSEMBLY

MODELS 3012H AND 3016H

| REF. NO. | PART NO. | DESCRIPTION | NO. REQ'D |
|-------------|-------------|---|--------------|
| 1 | 1743639 | Pedal Assembly | 1 |
| 2 | 1120210 | Roll Pin 3/16 x 13/16 | 1 |
| 3 | 1185802 | Flange Bushing | 2 |
| 4 | 1743693 | Hydro Pedal Support | 1 |
| 5 | 1107386 | Flat Washer 5/8 | 2 |
| 6 | 1741857 | Accelerator Shaft Assembly | 1 |
| 7 | 1110150 | Lock Hex Nut 3/8-24 | 1 |
| 8 | 1733963 | Ball Joint | 1 |
| 9 | 1741866 | Speed Control Rod | 1 |
| 10 | 1100049 | Hex Hd. Screw 3/8-16 x 2-1/4 | 2 |
| 11 | 1107383 | Flat Washer 3/8 | 10 |
| 12 | 1741334 | V-Belt 84.5" | 1 |
| 13 | 1733398 | Lock Nut 3/8-16 | 6 |
| 14 | 1748491 | Special Pivot | 1 |
| 15 | 1714233 | Snap Bushing | 2 |
| 16 | 1741858 | Cam Plate Rod | 1 |
| 17 | 1746948 | Cam Plate Arm Ass'y (A) | 1 |
| | 1751881 | Cam Plate Arm Ass'y (B) | 1 |
| 18 | 1720612 | Extension Spring | 1 |
| 19 | 1100360 | Cotter Pin 3/16 x 1 | 1 |
| 20 | 1728908 | Compression Spring | 1 |
| 21 | 1746944 | Brake Rod | 1 |
| 22 | 1704692 | Roll Pin 1/8 x 1 (A) | 2 |
| | 1120210 | Roll Pin 3/16 x 13/16 (B) | 2 |
| 23 | 1746947 | Arm Assembly (A) | 1 |
| | 1751880 | Arm Assembly (B) | 1 |
| 24 | 1751063 | Brake Lock Rod | 1 |
| 27 | 1741885 | Brake Pedal Assembly (A) | 1 |
| | 1751882 | Brake Pedal Assembly (B) | 1 |
| 28 | 1100350 | Cotter Pin 1/8 x 1 | 2 |
| 29 | 1728694 | Foot Rest | 1 |
| 30 | 1100359 | Cotter Pin 1/8 x 5/8 | 5 |
| 31 | 1118802 | Retaining Ring | 2 |
| 32 | 1741851 | Control Pin | 1 |
| 33 | 1720699 | Cushion Block | 1 |
| 34 | 1720928 | Extension Spring | 2 |
| 35 | 1743386 | Speed Control Arm | 1 |
| 36 | 1720361 | Thrust Washer | 2 |
| 37 | 1720523 | Neutralizing Arm | 2 |
| 38 | 1720529 | Thrust Washer | 1 |
| 39 | 1185732 | Retaining Ring | 1 |
| 40 | 1186309 | Flange Lock Screw 1/4-20 x 5/8 | 1 |
| 41 | 1186389 | Flange Lock Nut 1/4-20 | 1 |
| 42 | 1744566 | Retaining Ring | 2 |
| 43 | 1747872 | Washer | A/R |
| 44 | 1750352 | Tire 20-8.00 x 10 | 2 |
| 45 | 1718086 | Valve Stem | 2 |
| 46 | 1750350 | Wheel Disc | 2 |
| 47 | 1747874 | U-Bolt | 2 |
| 48 | 1748146 | Square Key 1/4 x 2-1/2 | 2 |
| 49 | 1719694 | Clamp Saddle | 2 |
| 50 | | Transaxle, Peerless Model 1327 (See breakdown page 24) | 1 |

| REF. NO. | PART NO. | DESCRIPTION | NO. REQ'D |
|-------------|-------------|---|--------------|
| 51 | 1720720 | Gasket | 1 |
| 52 | 1741994 | Eaton Hydrostatic Transmission Model 7 | 1 |
| 53 | 1111614 | Hex Hd. Screw 3/8-16 x 3 | 4 |
| 54 | 1100905 | Woodruff Key 1/8 x 1/2 | 2 |
| 55 | 1747166 | Set Screw 1/4-28 x 3/8 | 3 |
| 56 | 1744089 | Hydro Sheave | 1 |
| 57 | 1741953 | Fan | 1 |
| 58 | 1111599 | Hex Screw 1/4-20 x 5/8 | 1 |
| 59 | 1100241 | Lock Washer 1/4 | 1 |
| 60 | 1107381 | Flat Washer 1/4 | 1 |
| 61 | 1100242 | Lock Washer 5/16 | 3 |
| 62 | 1744090 | Idler | 1 |
| 63 | 1741861 | Idler Arm | 1 |
| 64 | 1701322 | Extension Spring | 1 |
| 65 | 1724929 | Thrust Washer | 2 |
| 66 | 1728030 | Sleeve | 1 |
| 67 | 1100064 | Hex Hd. Screw 1/2-13 x 1-1/2 | 1 |
| 68 | 1734514 | Lock Nut 1/2-13 | 1 |
| 69 | 1107385 | Flat Washer 1/2 | 1 |
| 70 | 1186330 | Flange Lock Screw 5/16-18 x 7/8 | 4 |
| 71 | 1186391 | Flange Lock Nut 5/16-18 | 1 |
| 72 | 1741867 | Bracket | 1 |
| 73 | 1747186 | Push On Cap | 1 |
| 74 | 1741859 | Neutral Plate | 1 |
| 75 | 1732369 | Spacer | 1 |
| 76 | 1703052 | Special Washer | 1 |
| 77 | 1741872 | Neutral Plate Support | 1 |
| 78 | 1741873 | Neutral Plate Bracket | 1 |
| 79 | 1742332 | Lever | 1 |
| 80 | 1186231 | Hex Nut 3/8-16 | 1 |
| 81 | 1100255 | Flat Washer 5/16 | 3 |
| 82 | 1100255 | Flat Washer 5/16 | 4 |
| 83 | 1732499 | Lock Nut 5/16-18 | 4 |
| 84 | 1186345 | Flange Screw 3/8-16 x 3/4 | 3 |
| 85 | 1720706 | Bearing | 1 |
| 86 | 1743638 | Hydro Pedal Pad | 1 |
| 87 | 1749764 | Idler | 1 |
| 88 | 1747875 | Grip | 1 |
| 89 | 1713783 | Spacer | 1 |
| 90 | 1747873 | Cap | 2 |
| 91 | 1100256 | Flat Washer 3/8 | 2 |
| 92 | 1748491 | Pivot Block | 1 |
| 93 | 1186230 | Hex Nut 5/16-18 | 3 |
| 94 | 1100242 | Lock Washer 5/16 | 3 |

• Common Hardware Purchase Locally (Grade 5 where applicable)

* Order parts from your local Tecumseh Power Products Engine

(A) 3012 S/N 0100101 - 0199999

3016 S/N 0300101 - 0399999

(B) 3012 S/N 0200101 - 0299999

3016 S/N 0400101 - 0499999

SUBURBAN TRACTOR

MODELS 3012 S/N 0100101 - 0199999
3016 S/N 0300101 - 0399999

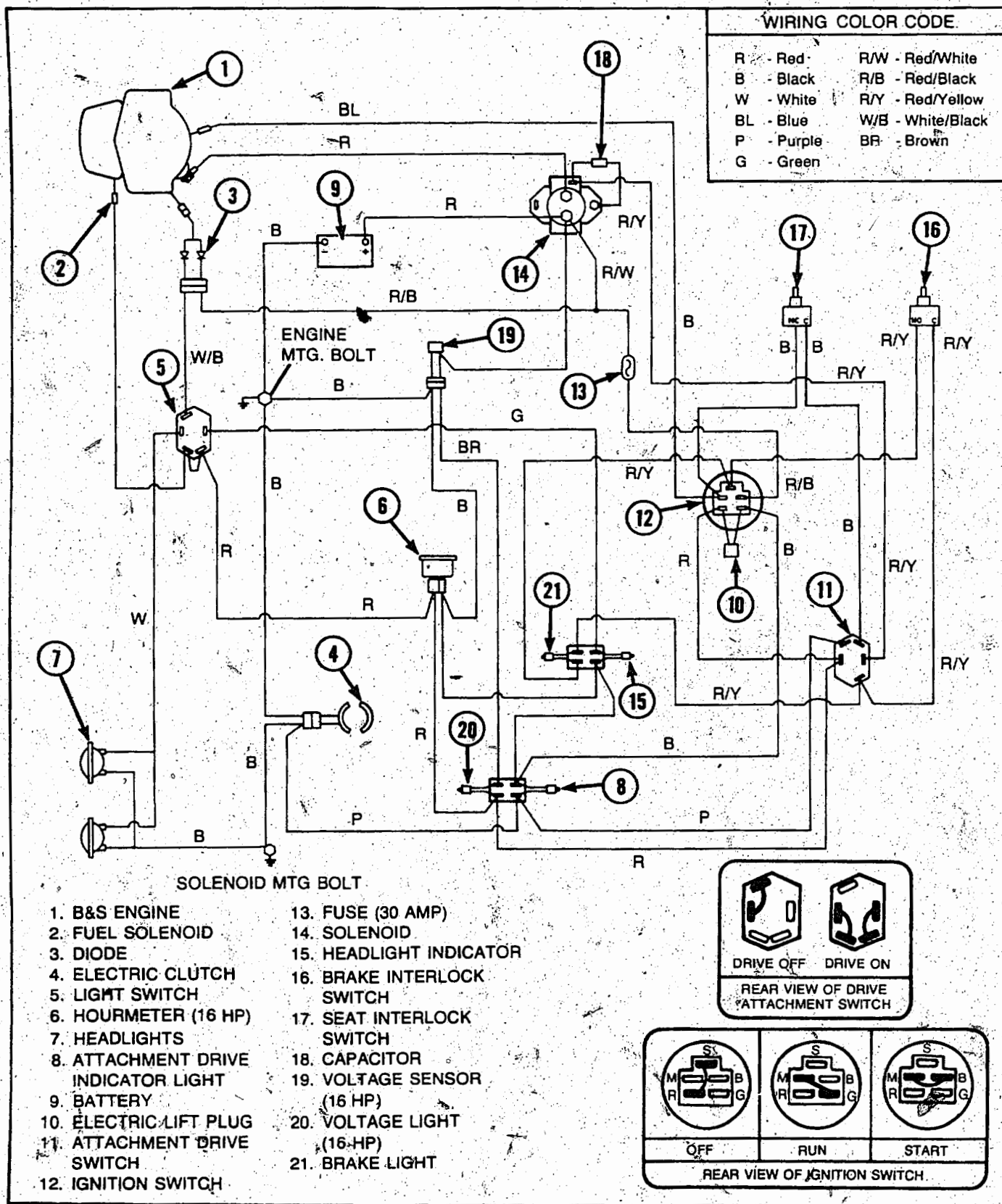

MODELS 3012 S/N 0200101 -0299999
3016 S/N 0400101 -0499999

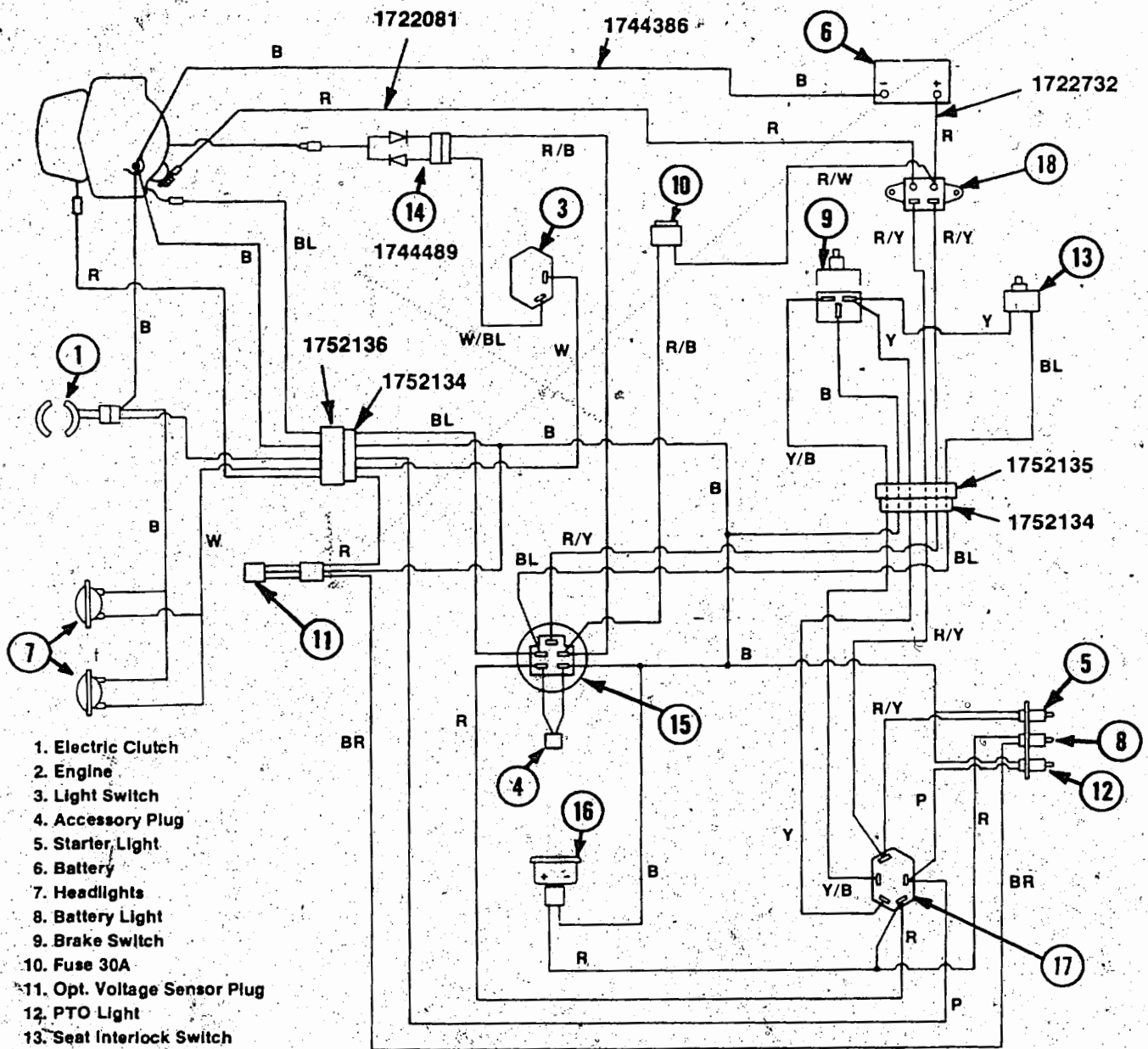

1. Electric Clutch
2. Engine
3. Light Switch
4. Accessory Plug
5. Starter Light
6. Battery
7. Headlights
8. Battery Light
9. Brake Switch
10. Fuse 30A
11. Opt. Voltage Sensor Plug
12. PTO Light
13. Seat Interlock Switch
14. Diode Assembly
15. Ignition Switch
16. Hour Meter (3016)
17. PTO Switch
18. Solenoid

WIRE COLOR CODE

| | |
|----------|------------------|
| R-RED | R/W-RED/WHITE |
| B-BLACK | Y/B-YELLOW/BLACK |
| W-WHITE | R/B-RED/BLACK |
| O-ORANGE | W/BL-WHITE/BLUE |
| Y-YELLOW | R/Y-RED/YELLOW |
| P-PURPLE | BR-BROWN |
| BL-BLUE | |

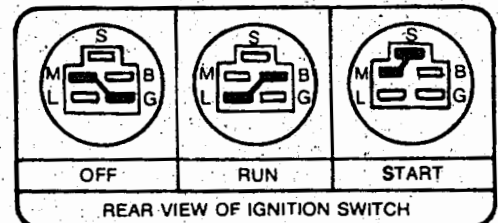
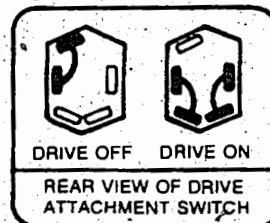

ELECTRICAL ASSEMBLY



MODELS 3012 S/N 0100101 - 0199999
3016 S/N 0300101 - 0399999

MODELS 3012H AND 3016H

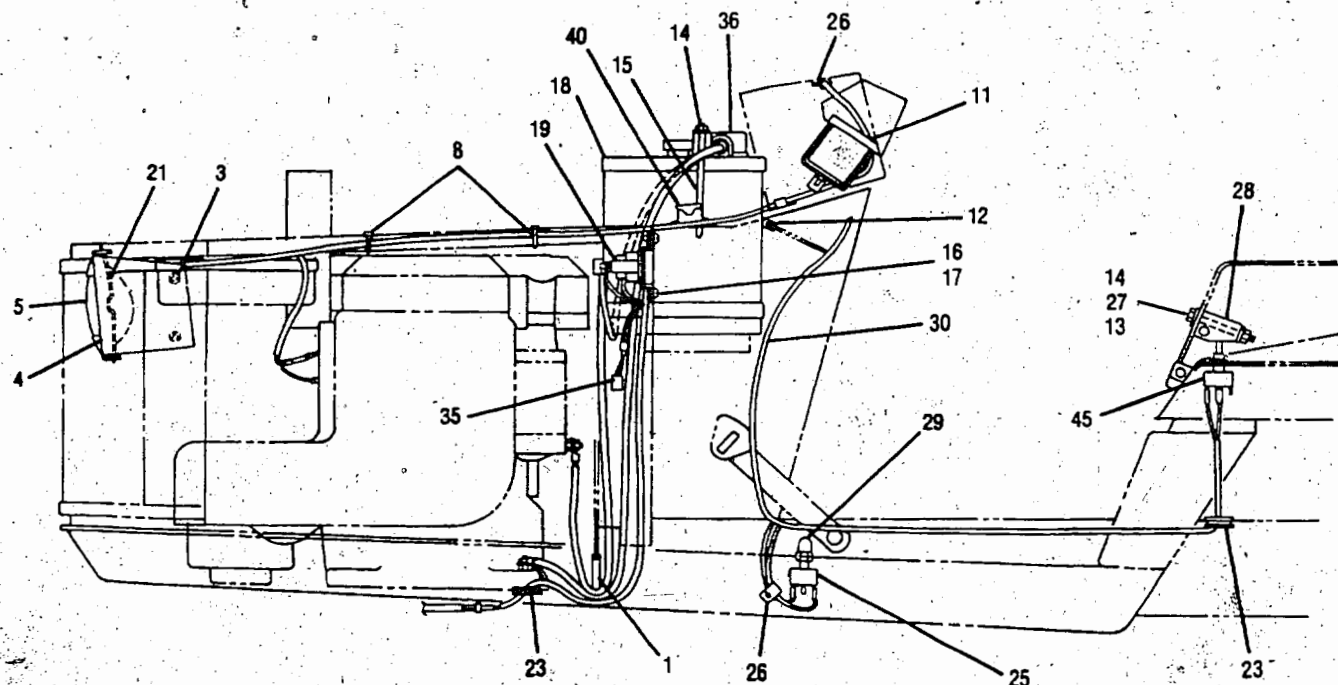

| REF. NO. | PART NO. | DESCRIPTION | NO. REQ'D |
|----------|----------|-------------------------------|-----------|
| 1 | 1737454 | Wear Strip | 2 |
| 2 | 1722732 | Battery Cable (Pos.) | 1 |
| 3 | 1186389 | Flange Lock Nut 1/4-20 | 4 |
| 4 | 1744021 | Light Support | 1 |
| 5 | 1726435 | Headlight | 2 |
| 6 | 1747167 | Cap | 1 |
| 7 | 1742113 | Capacitor | 1 |
| 8 | 1735531 | Wire Tie | 4 |
| 9 | 1744386 | Battery Cable (Neg.) | 1 |
| 10 | 1750767 | Lense | 1 |
| 11 | 1748719 | Hour Meter (Optional on 3012) | 1 |
| 12 | 1744580 | Seal Strip | 1 |
| 13 | 1107381 | Flat Washer 1/4 | 2 |
| 14 | 1734398 | Hex Lock Nut 1/4-20 | 5 |
| 15 | 1742173 | J-Bolt | 1 |
| 16 | 1115815 | Phil. Hd. Screw #10-24 x 5/8 | 2 |
| 17 | 1185985 | Nut #10-24 | 2 |
| 18 | 1747674 | Battery 42 AMP | 1 |
| 19 | 1740056 | Solenoid | 1 |
| 20 | 1744489 | Diode Assembly | 1 |
| 21 | 1744022 | Retainer | 2 |
| 22 | 1186230 | Hex Nut 5/16-18 | 1 |
| 23 | 1748014 | Grommet | 2 |
| 24 | 1744387 | Starter Cable | 1 |

| REF. NO. | PART NO. | DESCRIPTION | NO. REQ'D |
|----------|----------|--------------------------------|-----------|
| 25 | 1733575 | Switch | 2 |
| 26 | 1747738 | J-Clip | 4 |
| 27 | 1100089 | Hex Screw 1/4-20 x 2-1/2 | 1 |
| 28 | 1735265 | Pivot Block | 1 |
| 29 | 1733576 | Switch Seal | 1 |
| 30 | 1750980 | Main Wiring Harness | 1 |
| 31 | 1750976 | PTO Switch | 1 |
| 32 | 1750977 | Light Switch | 1 |
| 33 | 1750979 | Ignitin Switch (Incl. Ref. 34) | 1 |
| 34 | 1718266 | Ignition Key | 1 |
| 35 | 1751004 | Voltage Sensor (3016) | 1 |
| 36 | 1739631 | Cover | 1 |
| 37 | 1749171 | J-Clip | 2 |
| 38 | 1186020 | Thd Cut Screw 6-32 x 3/8 | 2 |
| 39 | 1748085 | Lamp Indicator (3016) | 2 |
| | 1748085 | Lamp Indicator (3012) | 1 |
| 40 | 1743516 | Replacement Fuse, 30A | 1 |
| 41 | 1738695 | Keps Nut 6-32 | 4 |
| 42 | 1751572 | Bulb (3016) | 2 |
| | 1751572 | Bulb (3012) | 1 |
| 43 | 1751649 | Retainer | 1 |
| 44 | 1750963 | Screw, 6-32 x 1/2 | 4 |
| 45 | 1742658 | Switch | 1 |

• Common Hardware - Purchase Locally

SUBURBAN TRACTOR

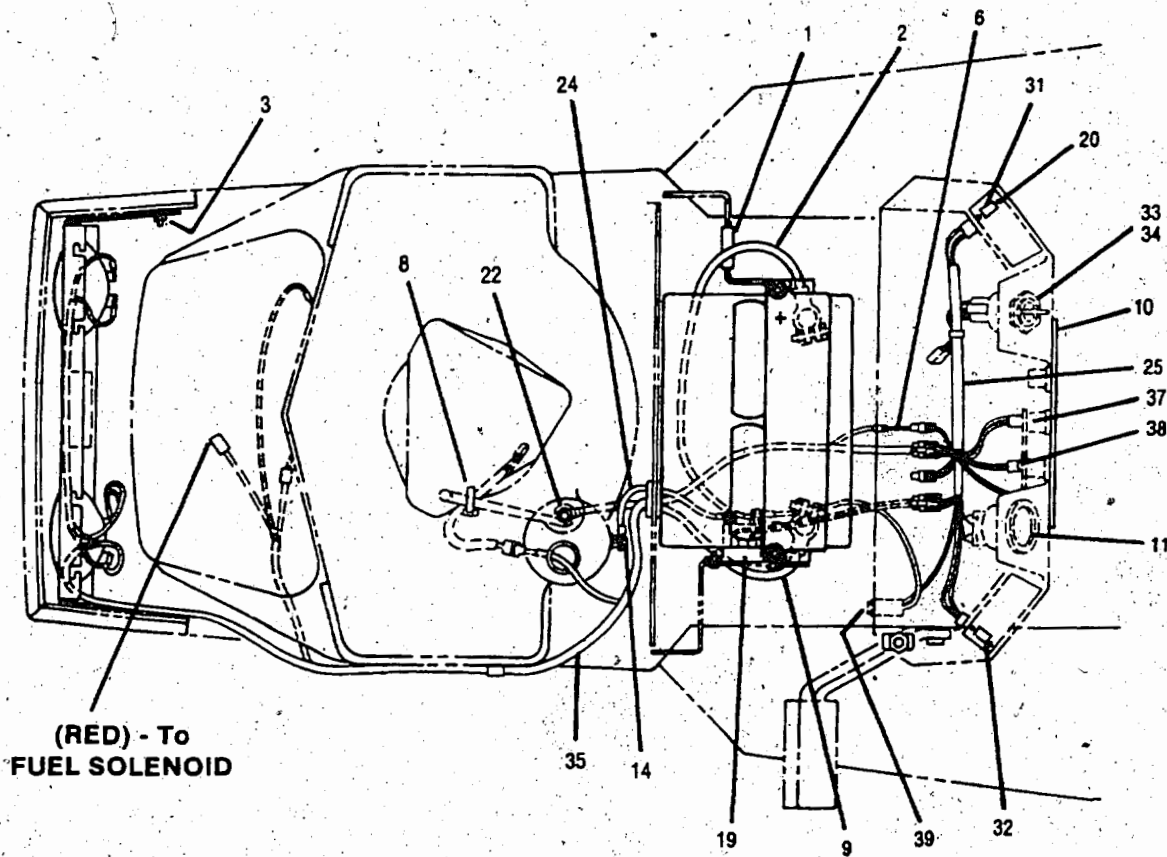

**MODELS 3012 S/N 0200101 -0299999
3016 S/N 0400101 -0499999**

MODELS 3012H AND 3016H

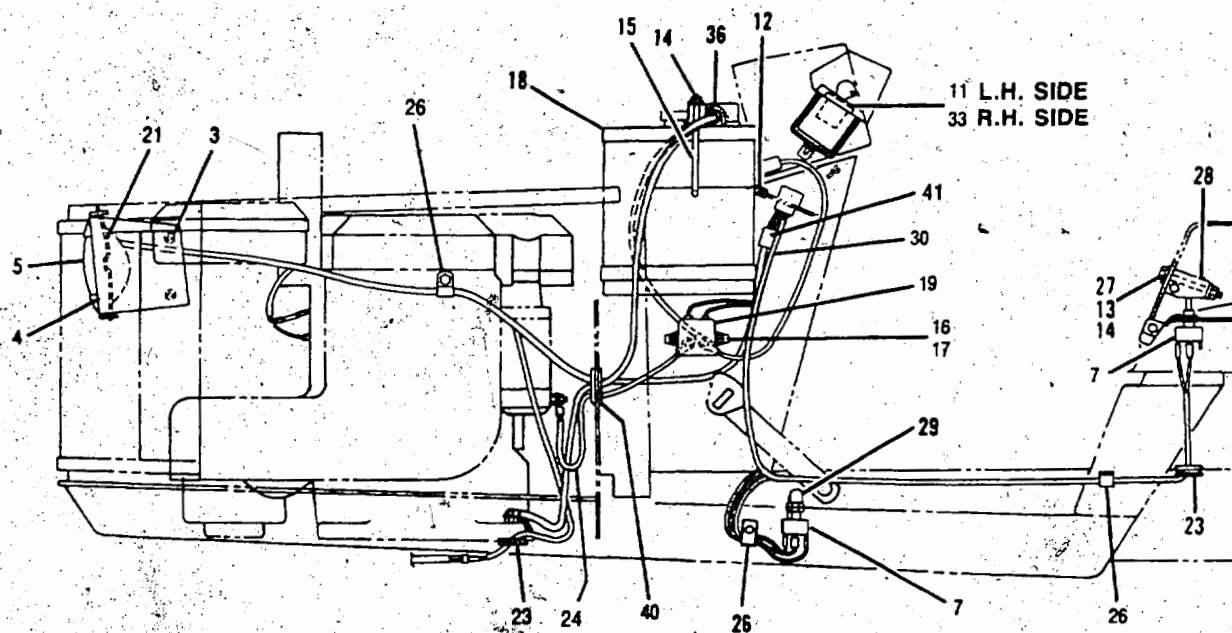

| REF. NO. | PART NO. | DESCRIPTION | NO. REQ'D |
|----------|----------|------------------------------|-----------|
| 1 | 1737454 | Wear Strip | 1 |
| 2 | 1722732 | Battery Cable (Pos.) | 1 |
| 3 | 1186389 | Flang Lock Nut 1/4-20 | 4 |
| 4 | 1744021 | Light Support | 1 |
| 5 | 1726435 | Headlight | 2 |
| 6 | 1744489 | Diode Ass'y | 1 |
| 7 | 1742658 | Switch | 2 |
| 8 | 1735531 | Wire Tie | 3 |
| 9 | 1744386 | Battery Cable (Neg) | 1 |
| 10 | 1752516 | Lense | 1 |
| 11 | 1748719 | Hour Meter (3016) | 1 |
| 12 | 1744580 | Seal Strip | 1 |
| 13 | 1107381 | Flat Washer 1/4 | 2 |
| 14 | 1734398 | Hex Lock Nut 1/4-20 | 4 |
| 15 | 1742173 | J-Bolt | 2 |
| 16 | 1115815 | Phil. Hd. Screw #10-24 x 5/8 | 2 |
| 17 | 1185986 | Nut #10-24 | 2 |
| 18 | 1751498 | Battery | 1 |
| 19 | 1752137 | Solenoid | 1 |
| 20 | 1750963 | Screw 6-32 x 1/2 | 4 |
| 21 | 1744022 | Retainer | 2 |

| REF. NO. | PART NO. | DESCRIPTION | NO. REQ'D |
|----------|----------|---------------------------------|-----------|
| 22 | 1186230 | Hex Nut 5/16-18 | 1 |
| 23 | 1748014 | Grommet | 2 |
| 24 | 1722081 | Starter Cable | 1 |
| 25 | 1752134 | Console Wire Harness | 1 |
| 26 | 1747738 | J-Clip | 3 |
| 27 | 1100089 | Hex Screw 1/4-20 x 2-1/2 | 1 |
| 28 | 1735265 | Pivot Block | 1 |
| 29 | 1733576 | Switch Seal | 1 |
| 30 | 1752135 | Interlock Harness | 1 |
| 31 | 1750976 | PTO Switch | 1 |
| 32 | 1751496 | Light Switch | 1 |
| 33 | 1750979 | Ignition Switch (Incl. Ref. 34) | 1 |
| 34 | 1718266 | Ignition Key | 1 |
| 35 | 1752136 | Harness, Engine | 1 |
| 36 | 1739631 | Cover | 1 |
| 37 | 1751572 | Bulb | 3 |
| 38 | 1186020 | Thd Cut Screw 6-32 x 3/8 | 1 |
| 39 | 1743516 | Replacement Fuse, 30A | 1 |
| 40 | 1752809 | Grommet | 1 |
| 41 | 1752132 | Voltage Sensor (3016) | 1 |

• Common Hardware - Purchase Locally