

George Montgomery Co. Deed 20th June 1837

Warrant dated 3rd May 1837
 Surveyed June 2nd 1837 for Mathias Adams who resides in this State a tract of 200 acres of Pine Land on the eastern side of Pine Creek bounded N. by Adams N.E. by Adams land S.E. by Pine Creek S. by Adams June 1837 Surveyed by J. H. Jordan & Co. Certified by J. J. Hanson Esq. Deput.

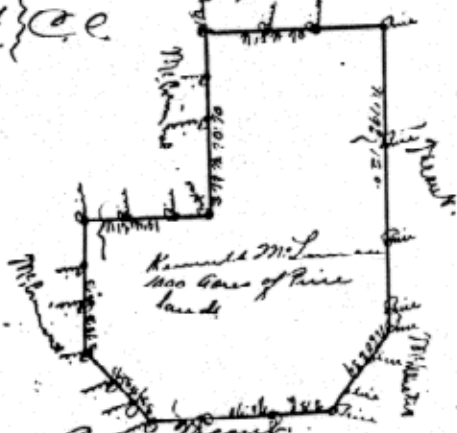

George Montgomery Co. Deput. Deed 1st June 1837

Warrant dated 6th March 1837 and Surveyed 7th Dec 1837 for Daniel M. Quinn who resides a tract of 100 acres of Pine Land bounded N. by M. Quinn S. by M. Quinn and are also proved by James Jordan & Co. Deput. of 17th Dec 1837 Surveyed by J. H. Jordan & Co. Certified by John J. Hanson Esq.

Daniel M. Quinn } C.C.
 August M. Bee } C.C.